

202405432
 RECORDED ON
 10/18/2024 12:30:23 PM
 SLIDE/PAGE: F 79-80
 PLAT FEE: 69.00
 PAGES: 2
 CHRISTY BONSTELL
 RECORDER OF DEEDS
 WARREN COUNTY, MO

RECORD PLAT SUBMITTAL
 05-12-2024

RECORD PLAT
WESTWOOD FARMS
 PLAT ONE

ST. CHARLES ENGINEERING & SURVEYING, INC.
 801 S. FIFTH STREET, SUITE 202
 ST. CHARLES, MO 63801
 TEL: (636) 947-0607 FAX: (636) 947-2448
 ST. CHARLES ENGINEERING AND SURVEYING, INC.
 PROFESSIONAL ENGINEERING AND LAND SURVEYING CORPORATION
 MISSOURI STATE CERTIFICATE OF AUTHORITY - 001647 & 000379

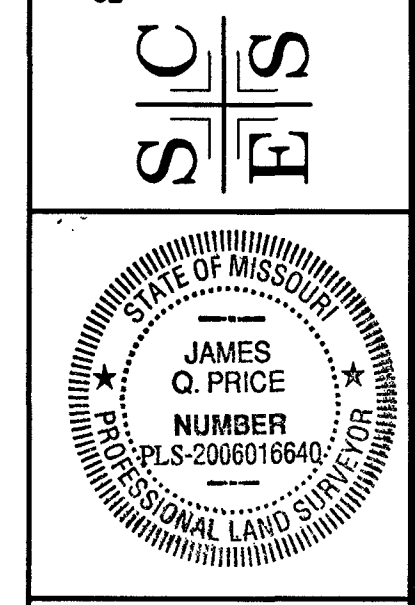

ORDER NO.
 2023086
 DATE
 05/12/2024
 2 OF 2